

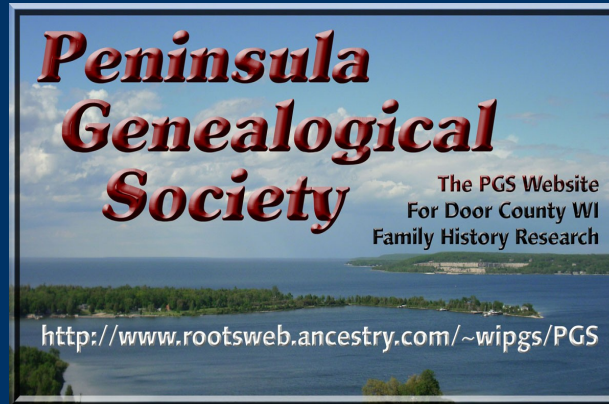

**Hope this will Help you to take pictures at Cemeteries**  
**This Slide Presentation was prepared by**  
**Sue Hohneke**  
**for the Peninsula Genealogical Society (PGS) Meeting**  
**on 27 May 2010.**





# **TIPS FOR TAKING THE BEST PICTURES OF CEMETERY STONES**

**27 May 2010**

---

---

# Take "View" Pictures of Cemetery too



**Pilgrims' Rest Cemetery**



# Look for the Family Plot



**In ground marker**



**Family Plot**



# Check ALL the SIDES of stones!



**Front of stone**



**Side of Stone**





# Check for FOOTSTONES!

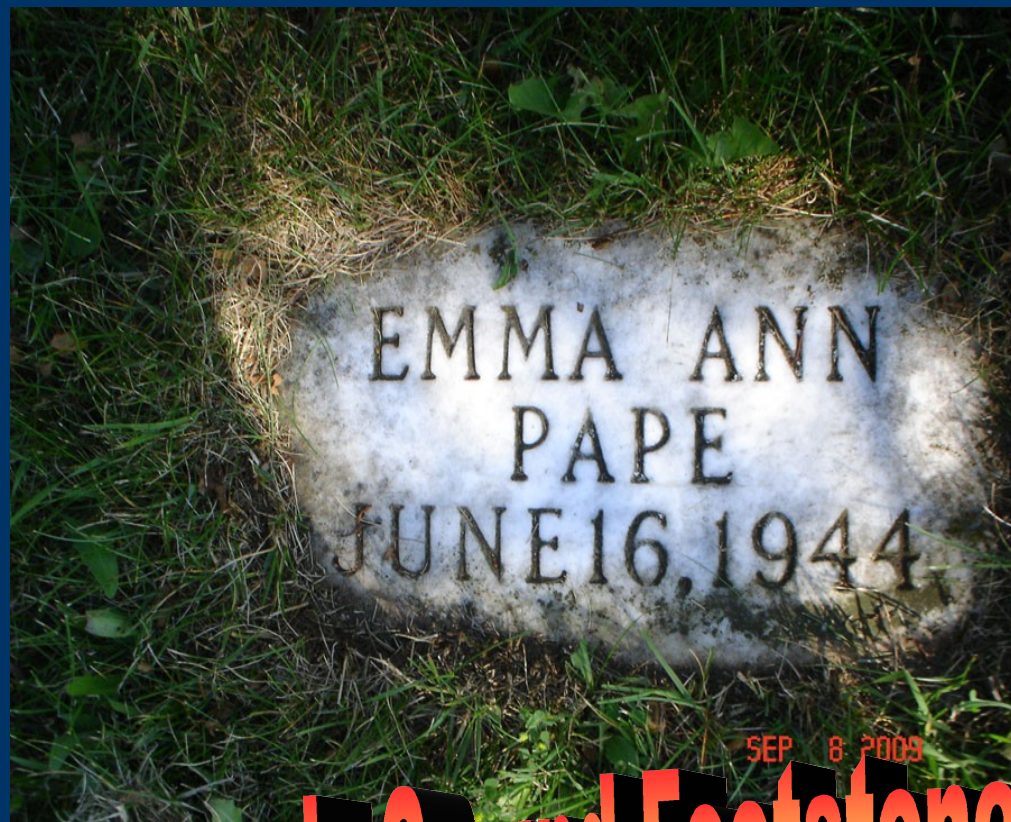

**Side of stone base**



**In Ground Footstone**

**Newer Family Stone -OLD Footstone**

---

---



**Don't Forget:**  
**Check to see if stone needs to be**  
**DUG OUT!**



**BEFORE**



**AFTER**



# CLEANING STONES can make them more readable!



**BEFORE**



**AFTER**



# Your Cemetery KIT: Leave it in the car & be ready to GO!

## BAG



and/or

## BUCKET





# Your Cemetery KIT:

## Spray WATER Bottles



## Plastic Bristle Brushes



T  
O  
O  
L  
S

Spade

Plastic Scrapers

Grass Clipper

Knife/Saw to cut Sod

?-make your own?



CUSHION FOR KNEELING  
GARBAGE BAG FOR  
SOD CLUMPS OR TRASH





# Your Cemetery KIT: Don't Forget a

# MIRROR!

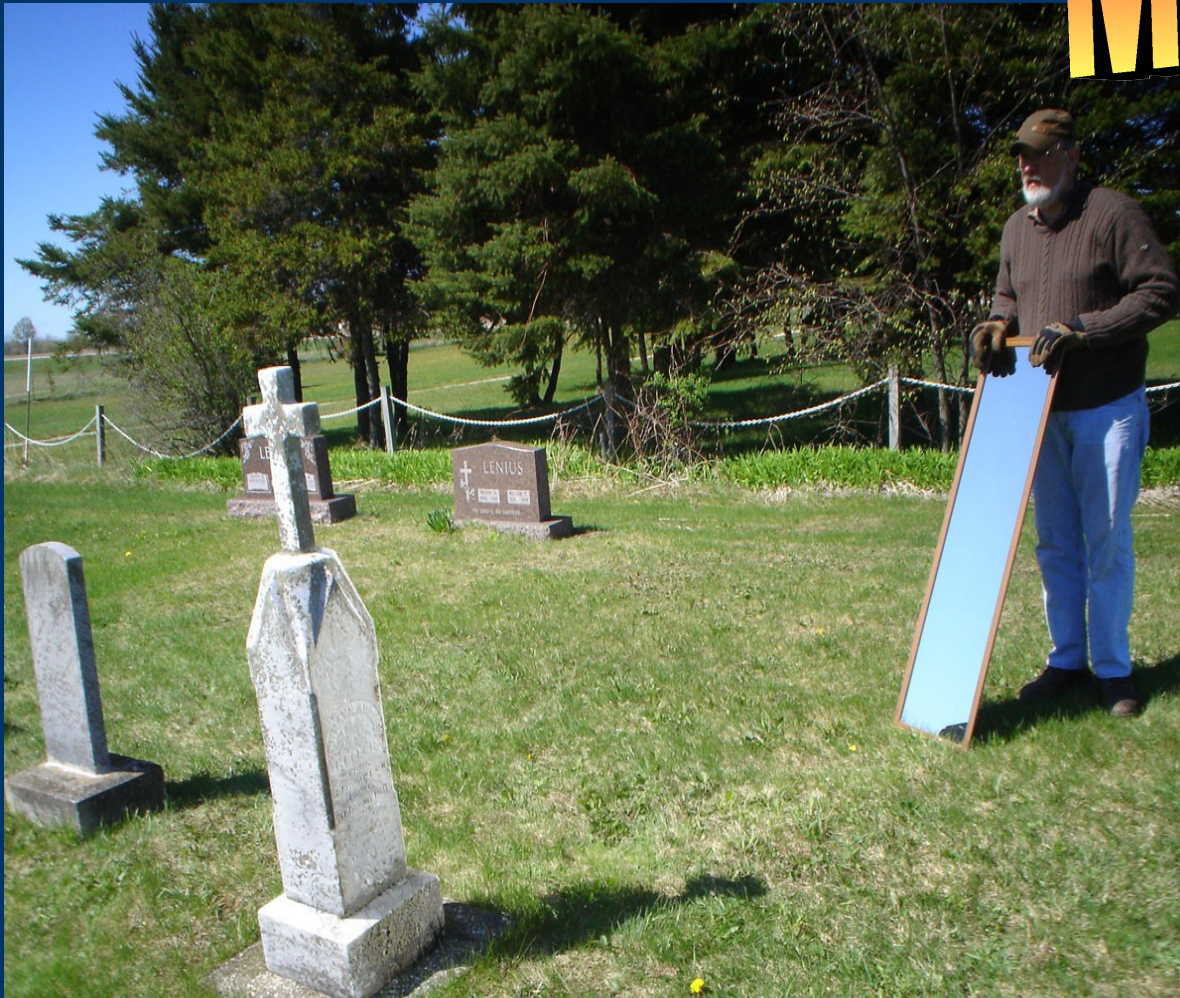

Control the amount  
of light you want  
and the angle you  
want it to be

Watch the lettering  
just POP OUT!



Use only

**Water**

**to clean stones!!**

**EVERYTHING ELSE  
DAMAGES STONES!**



**No Pressure Sprayers  
No Wire Bristle Brushes  
No Metal Scrapers  
No Chalk/Shaving Cream +**





**LICHEN can hide important lettering  
BUT it CAN be removed!**



**LICHEN!**

**Wet, Scrape, Wipe  
Repeat if necessary**

---

---



# CLEANING STONES of Lichen ONLY USING WATER!!

**SPRAY-Liberally (SOAK WELL)**

**SCRAPE off lichen-**

**WIPE with Towel-**

**REPEAT if needed**





**WATER!! - just wetting a stone  
can bring out the lettering!**



**Angle-lit with mirror**





**No MIRROR**



**With MIRROR**



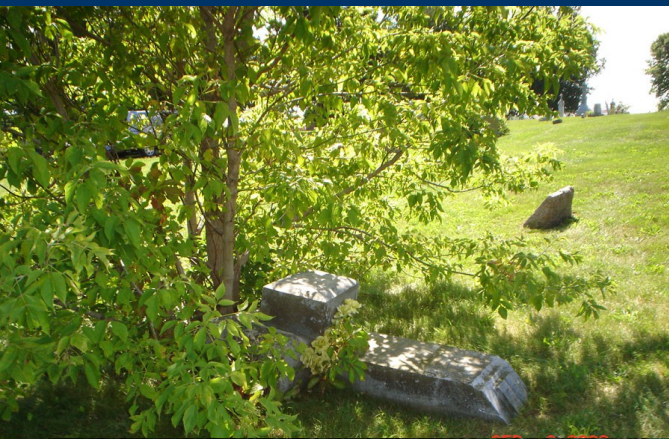

# Broken Stones!

Clean - then  
Take FULL View &  
CLOSE-UP pictures

**CHECK SIDES & TOPS TOO!**



# Beginning a Cemetery Photo Survey..

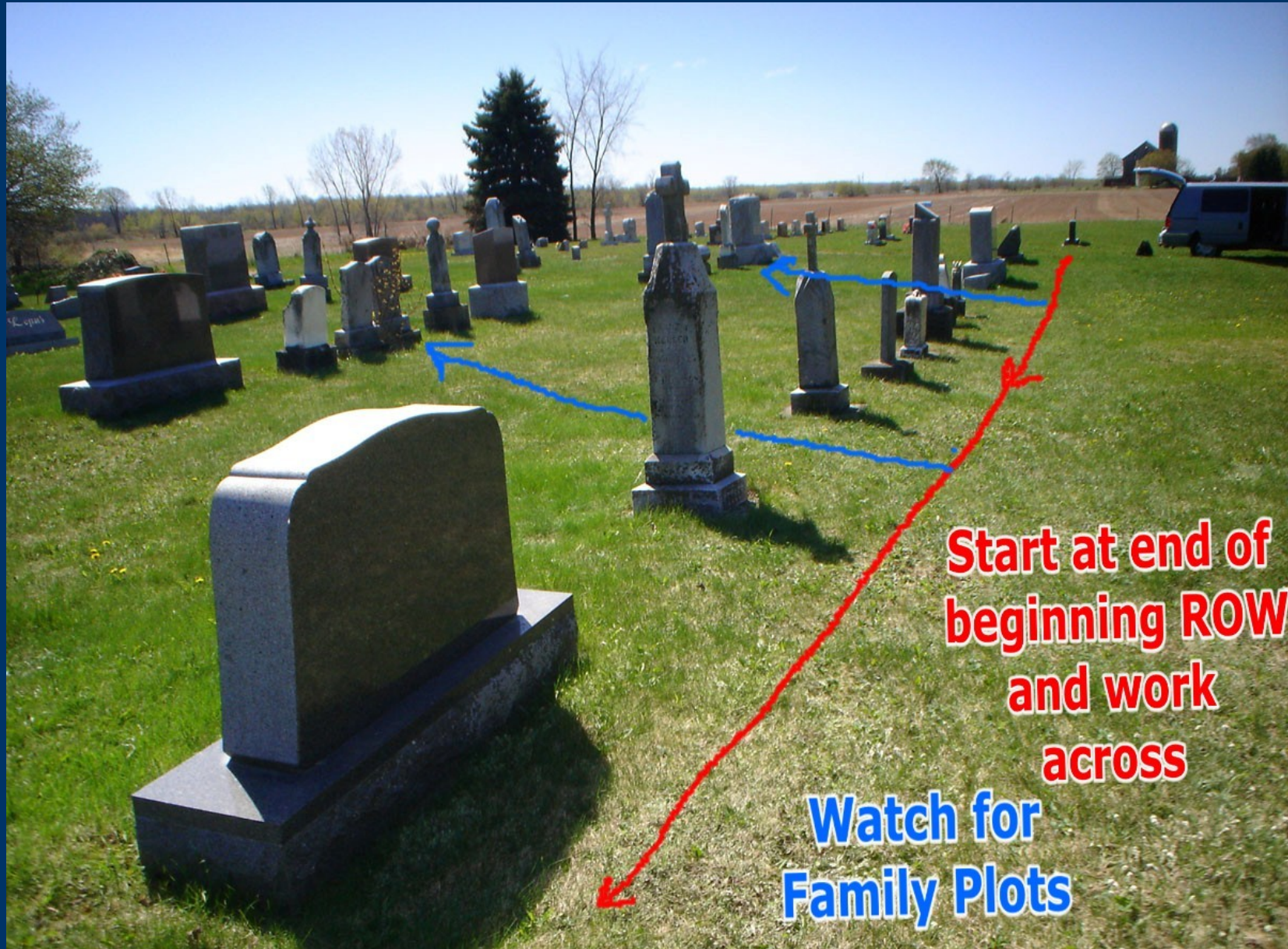

Start at end of  
beginning ROW  
and work  
across

Watch for  
Family Plots



# Check ALL sides of Stones

## Service markers many times on back

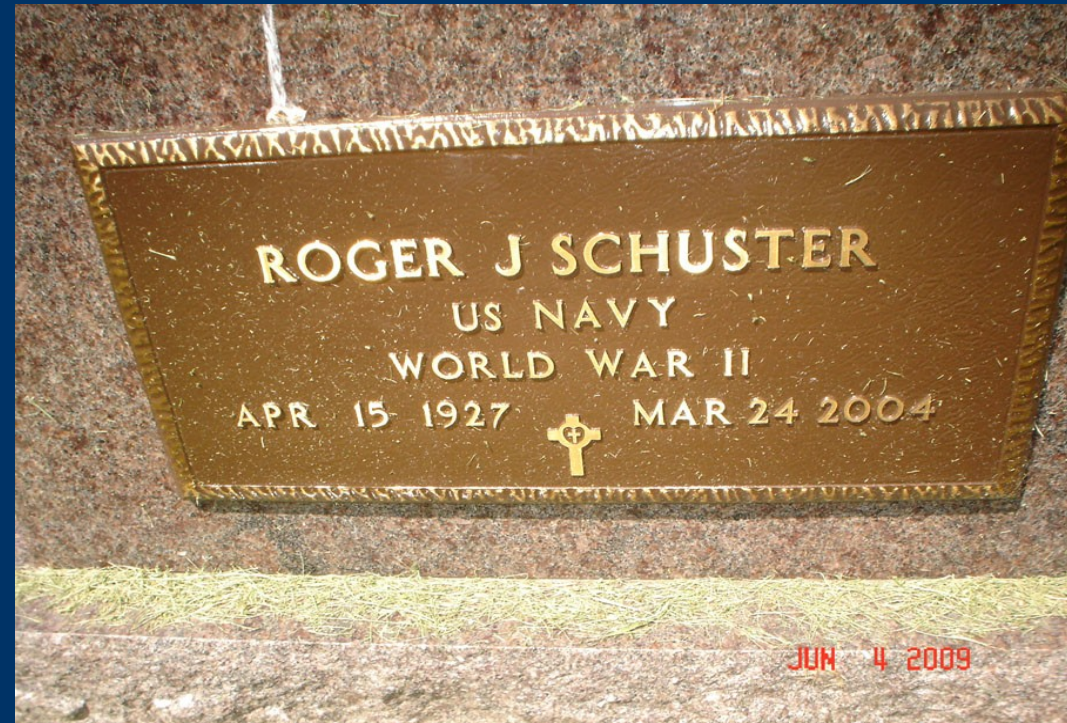

**Front of Stone** & **Back of Stone**



# Check ALL SIDES of Stones!

## Take FULL & CLOSE-UP pictures where needed!



# Front of Stone



# Back of Stone

CHECK SIDES & TOPS TOO!



# Check BUSHES & TREES for Stones!

## Take FULL & CLOSE-UP pictures!



# Full View

# &

# Close-ups

NOT MUCH FUN TO DO BUT GREAT TO FIND THE STONE(S)!

---

---



# When Flowers+ Block Stones

Take FULL & Close-up pictures!



**Full View**

**Close-ups**



**At END of DAY's  
Work (if not finished)  
take "View" picture of  
where you will begin next time..**

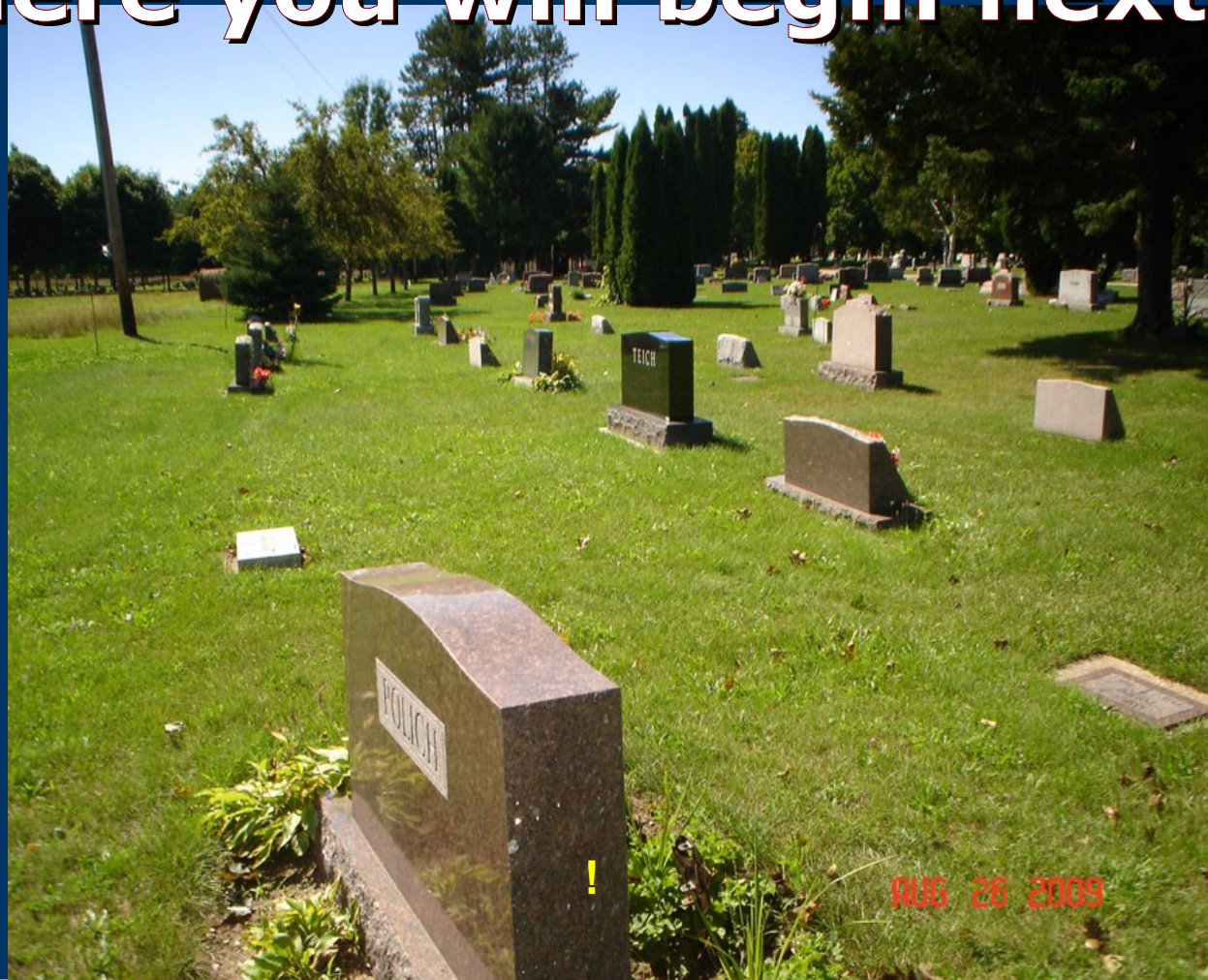



# What we're doing does make a difference and is appreciated!....

“Thank you very much for posting the information on the Schumacher/Nasewaupee Cemetary on your website and the outstanding photos of the headstones. I have been trying to find the burial location for my great-grandfather, Samuel Thomas McCumby for a long time.” - Kris McCUMBY

“I did find my grandfather's parents' headstone picture on your website (thanks!). Their names are James and Emily Belanger.” - Kay BELANGER JOHNSON

“I really enjoyed looking at the Liberty Grove cemetery site and found pictures of my grandparents (Anna and August Anderson) and great aunt and uncle (Elmer and Clara Olson). Anna's gravestone was in terrible shape and I contacted my brother in CA (I live in FL) and we contacted a place in Sturgeon Bay and had a new headstone put in.” - Nancy ANDERSON

“I never realized that the WOBSEY Family line ended with Albert's children until today. And then it was wonderful to realize that YOU found the website and had those pictures to share! That is really AWESOME!! Thank you so much” – Jim O'SULLIVAN

---

---



A photograph showing two young birds, possibly terns, nestled in a hollowed-out section of a tree trunk. The birds have white bodies, dark caps, and yellow beaks. The surrounding wood is light brown and textured.

**These little guys will be just starting out soon  
Just like we will be again this year  
But we'll be old hands at it by next fall!!**

**2010's project is up next.....**



# **CEMETERIES for 2010 Photo Surveys**

**\* we need volunteers!\***



**Pick a  
Section  
to do  
this  
summer!**

**Bayside Cemetery**



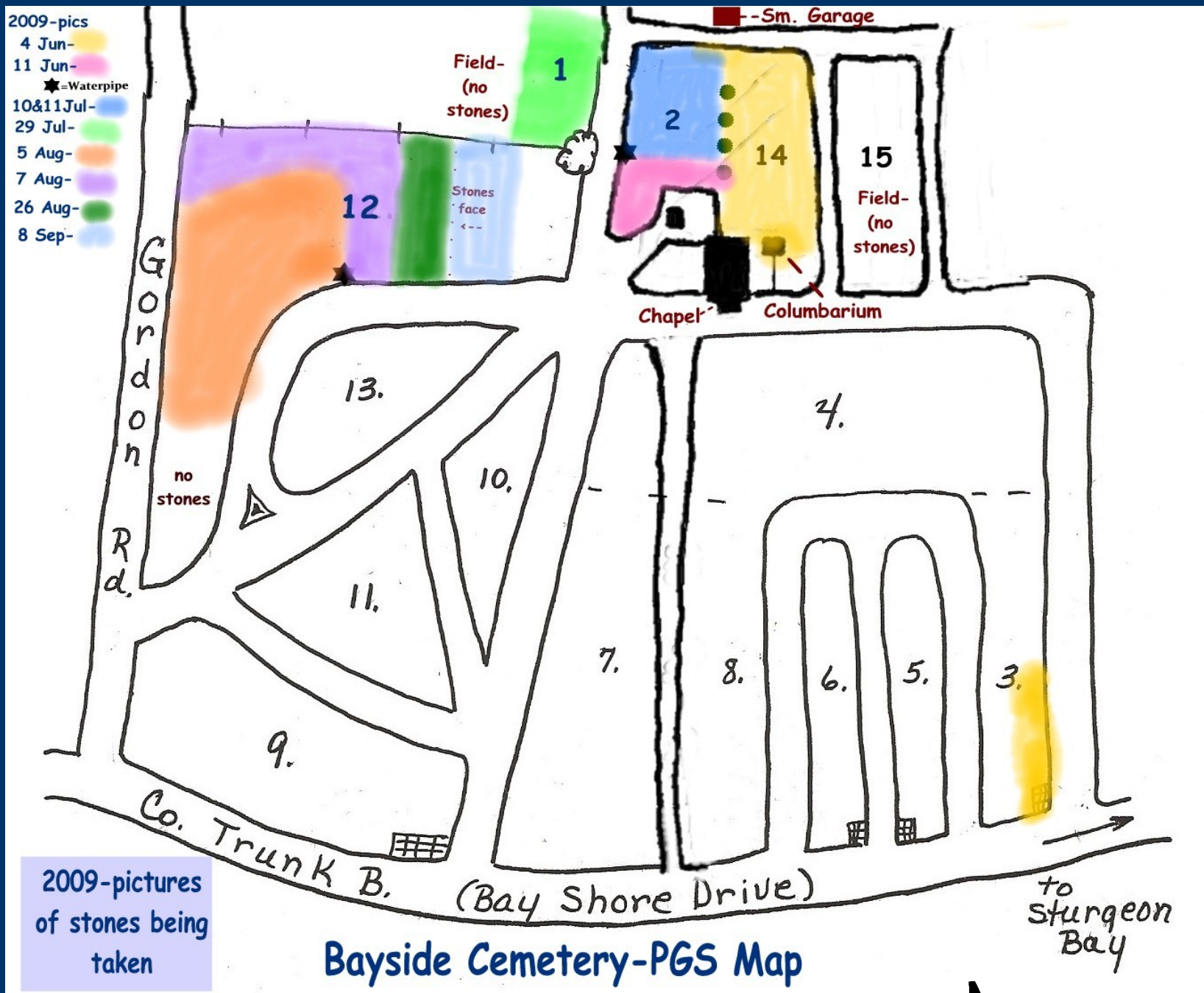

**Do a Photo Survey this summer at Bayside!**

**Choose your own Section!**

**2009=4 Sections-(8)days of 2 hours work**



Or...

Choose your own  
Door Co. Cemetery  
to Photo Survey  
this summer!!

---

---



**Hope you will help take  
Photo Survey pictures  
for the PGS Website  
this summer!**

**Don't be afraid  
to come out  
and play!!**

**This Slide Presentation was prepared by  
Sue Hohneke  
for the Peninsula Genealogical Society (PGS) Meeting  
on 27 May 2010.**